

**vtech**<sup>®</sup>

**User's Manual**

# **Text & Go Learning Phone™**



© 2015 VTech  
Printed in China  
91-009704-004 (US)

Dear Parent,

At VTech®, we know how important the first day of school is for your child. To help prepare preschoolers for this important event, VTech® has developed the **Preschool Learning™** series of interactive toys.

**Preschool Learning™** features fun characters and inviting school themes that use technology to capture a child's attention and teach important preschool skills like spelling, counting and the alphabet. These vital skills are taught in a way that's both fun and highly engaging to maintain a child's interest. Children will also be introduced to fun school subjects such as art class, music class and even recess! With **Preschool Learning™**, learning is fun from day one!

At VTech®, we know that a child has the ability to do great things. That's why all of our electronic learning products are uniquely designed to develop a child's mind and allow them to learn to the best of their ability. We thank you for trusting VTech® with the important job of helping your child learn and grow!

Sincerely,

Your friends at VTech®

To learn more about VTech® toys, visit [vtechkids.com](http://vtechkids.com)

# INTRODUCTION

Thank you for purchasing the **VTech® Text & Go Learning Phone™!**

Learn and play with the **Text & Go Learning Phone™!** With nine interactive activities, your child will be engaged and entertained as they learn phonics, letters, words, music and play fun games!

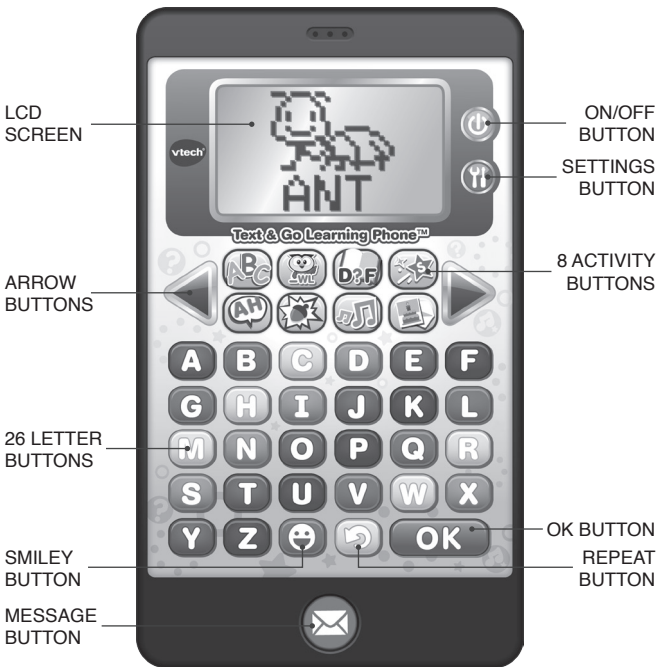

# INCLUDED IN THIS PACKAGE

- One VTech® Text & Go Learning Phone™
- One User's Manual

## WARNING:

All packing materials, such as tape, plastic sheets, packaging locks and tags are not part of this toy, and should be discarded for your child's safety.

## ATTENTION:

Pour la sécurité de votre enfant, débarrassez-vous de tous les produits d'emballage tels que rubans adhésifs, feuilles de plastique, attaches et étiquettes. Ils ne font pas partie du jouet.

## NOTE:

Please keep the user's manual as it contains important information.

Unlock the packaging locks:

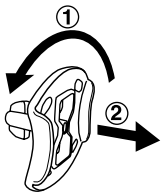

- ① Rotate the packaging locks 90 degrees counter-clockwise.
- ② Pull out the packaging locks.

# GETTING STARTED

## BATTERY INSTALLATION

1. Make sure the unit is turned **OFF**.
2. Locate the battery cover on the bottom of the unit.
3. Use a screwdriver to open the cover.
4. Install 2 new AA size (LR6/AM-3) batteries following the diagram inside the battery box. (The use of new, alkaline batteries is recommended for maximum performance.)
5. Replace the battery cover and tighten to secure.

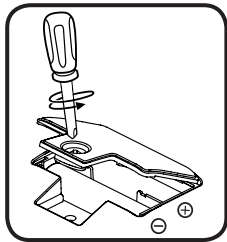

**Note: If there is no response when the unit is switched on, please insert new batteries and try switching it on again.**

## BATTERY NOTICE

- Use new alkaline batteries for maximum performance.
- Use only batteries of the same or equivalent type as recommended.
- Do not mix different types of batteries: alkaline, standard (carbon-zinc) or rechargeable (Ni-Cd, Ni-MH), or new and used batteries.
- Do not use damaged batteries.
- Insert batteries with the correct polarity.
- Do not short-circuit the battery terminals.
- Remove exhausted batteries from the toy.
- Remove batteries during long periods of non-use.
- Do not dispose of batteries in fire.
- Do not charge non-rechargeable batteries.
- Remove rechargeable batteries from the toy before charging (if removable).
- Rechargeable batteries are only to be charged under adult supervision.

# PRODUCT FEATURES

## 1. ON/OFF BUTTON

Press the **ON/OFF BUTTON** to turn the unit **ON**. Press the **ON/OFF BUTTON** again to turn the unit **OFF**.

**Note:** You can add your name to the unit after inserting the batteries and pressing the **ON/OFF BUTTON** to turn on the unit for the first time.

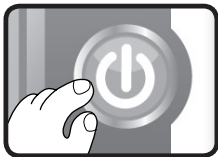

## 2. SETTINGS BUTTON

Press the **SETTINGS BUTTON** to add or change your name in the unit, adjust the volume, turn the background music on/off, or adjust the LCD contrast.

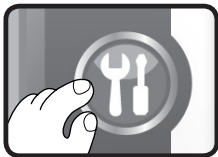

## 3. 8 ACTIVITY BUTTONS

Press one of the **8 ACTIVITY BUTTONS** to select an activity to play.



## 4. MESSAGE BUTTON

Press the **MESSAGE BUTTON** to enter the **Text & Type** activity to send and receive pretend text messages.



## 5. SMILEY BUTTON

Press the **SMILEY BUTTON** to hear fun sound effects or to choose funny pictures for your message in the **Text & Type** activity.

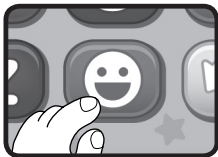

## 6. ARROW BUTTONS

Use the **ARROW BUTTONS** to make a selection or answer the questions in related activities.



## 7. OK BUTTON

Press the **OK BUTTON** to confirm the selection in related activities or send the message you've typed in the **Text & Type** activity.



## 8. 26 LETTER BUTTONS

Press the **LETTER BUTTONS** to learn letters and objects, answer questions in related activities, or to type a message.

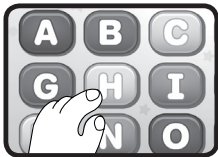

## 9. REPEAT BUTTON

Press the **REPEAT BUTTON** to repeat an instruction or question.



## 10.AUTOMATIC SHUT-OFF

To preserve battery life, the **Text & Go Learning Phone™** will shut off automatically after several minutes without any input. The unit can be turned on again by pressing the **ON/OFF BUTTON**.

## ACTIVITIES

### 1. LETTER EXPLORER

Press the **LETTER BUTTONS** to learn the letter name and an object that starts with that letter.



### 2. BEGINNING LETTERS

Remember the word shown on the screen, because the first letter will disappear. Press the corresponding **LETTER BUTTON** or use the **ARROW BUTTONS** to select the missing letter that completes the word. Then press the **OK BUTTON** to answer.



### 3. ALPHABET ORDER

Can you help find which letter is missing in the sequence? Press a **LETTER BUTTON** to answer.



### 4. LETTER STARS

Stars containing letters are shining in the sky. Press the **LETTER BUTTONS** that match the letters shown in the stars as fast as you can.





## 5. LETTER SOUNDS

Can you help find which letter makes this sound? Listen carefully to the sound, then press the corresponding **LETTER BUTTON** or use the **ARROW BUTTONS** to select a letter. Then press the **OK BUTTON** to answer. Once the questions have been answered correctly, the corresponding letter sound will be repeated.



## 6. AVOID THE ACORNS

Acorns are falling down. Use the **ARROW BUTTONS** to move the owl left or right to avoid the acorns.

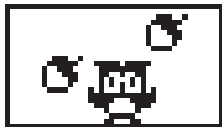

## 7. MUSICAL DANCE

Do you want to see the owl sing and dance with some friends? Use the **ARROW BUTTONS** to select a song, then press the **OK BUTTON** to see them sing and dance together.

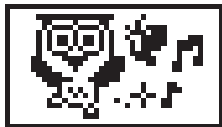

## 8. E-CARD FUN

You've got some e-cards. Use the **ARROW BUTTONS** to choose an e-card then press the **OK BUTTON** to read the e-card. A corresponding animation and short tune will be played.



## 9. TEXT & TYPE

Press the **MESSAGE BUTTON** to send and receive pretend text messages. Press the **LETTER BUTTONS** to type a message, or press the **SMILEY BUTTON** to choose something fun to add to your message. Then press the **OK BUTTON** or the **MESSAGE BUTTON** to send it.



## CARE & MAINTENANCE

1. Keep the unit clean by wiping it with a slightly damp cloth.
2. Keep the unit out of direct sunlight and away from any direct heat source.
3. Remove the batteries when the unit is not in use for an extended period of time.
4. Do not drop the unit on hard surfaces and do not expose the unit to moisture or water.

## TROUBLESHOOTING

If for some reason the program/activity stops working or malfunctions, please follow these steps:

1. Please turn the unit **OFF**.
2. Interrupt the power supply by removing the batteries.
3. Let the unit stand for a few minutes, then replace the batteries.
4. Turn the unit **ON**. The unit should now be ready to play again.
5. If the product still does not work, replace with a new set of batteries.

If the problem persists, please call our Consumer Services Department at 1-800-521-2010 in the U.S. or 1-877-352-8697 in Canada, and a service representative will be happy to help you.

## IMPORTANT NOTE:

Creating and developing **VTech**<sup>®</sup> products is accompanied by a responsibility that we at **VTech**<sup>®</sup> take very seriously. We make every effort to ensure the accuracy of the information which forms the value of our products. However, errors sometimes can occur. It is important for you to know that we stand behind our products and encourage you to call our Consumer Services Department at 1-800-521-2010 in the U.S., or 1-877-352-8697 in Canada with any problems and/or suggestions that you might have. A service representative will be happy to help you.

## NOTE:

This equipment has been tested and found to comply with the limits for a Class B digital device, pursuant to Part 15 of the FCC Rules. These limits are designed to provide reasonable protection against harmful interference in a residential installation. This equipment generates, uses and can radiate radio frequency energy and, if not installed and used in accordance with the instructions, may cause harmful interference to radio communications. However, there is no guarantee that interference will not occur in a particular installation. If this equipment does cause harmful interference to radio or television reception, which can be determined by turning the equipment off and on, the user is encouraged to try to correct the interference by one or more of the following measures:

- Reorient or relocate the receiving antenna.
- Increase the separation between the equipment and receiver.
- Connect the equipment into an outlet on a circuit different from that to which the receiver is connected.
- Consult the dealer or an experienced radio/TV technician for help.

**Caution:** Changes or modifications not expressly approved by the party responsible for compliance could void the user's authority to operate the equipment.



## PRODUCT WARRANTY

This Warranty is applicable only to the original purchaser, is non-transferable and applies only to "VTech" products or parts. This product is covered by a 3-month Warranty from the original purchase date, under normal use and service, against defective workmanship and materials. This Warranty does not apply to (a) consumable parts, such as batteries; (b) cosmetic damage, including but not limited to scratches and dents; (c) damage caused by use with non-VTech products; (d) damage caused by accident, misuse, unreasonable use, immersion in water, neglect, abuse, battery leakage, or improper installation, improper service, or other external causes; (e) damage caused by operating the product outside the permitted or intended uses described by VTech in the owner's manual; (f) a product or part that has been modified (g) defects caused by normal wear and tear or otherwise due to the normal aging of the product; or (h) if any VTech serial number has been removed or defaced.

Prior to returning a product for any reason, please notify the VTech Consumer Services Department, by sending an email to [vtechkids@vtechkids.com](mailto:vtechkids@vtechkids.com) or calling 1-800-521-2010. If the service representative is unable to resolve the issue, you will be provided instructions on how to return the product and have it replaced under Warranty. Return of the product under Warranty must adhere to the following rules:

If VTech believes that there may be a defect in the materials or workmanship of the product and can confirm the purchase data and location of the product, we will at our discretion replace the product with a new unit or product of comparable value. A replacement product or parts assumes the remaining Warranty of the original product or 30 days from the date of replacement, whichever provides longer coverage.

THIS WARRANTY AND THE REMEDIES SET FORTH ABOVE ARE EXCLUSIVE AND IN LIEU OF ALL OTHER WARRANTIES, REMEDIES AND CONDITIONS, WHETHER ORAL, WRITTEN, STATUTORY, EXPRESS OR IMPLIED. IF VTECH CANNOT LAWFULLY DISCLAIM STATUTORY OR IMPLIED WARRANTIES THEN TO THE EXTENT PERMITTED BY LAW, ALL SUCH WARRANTIES SHALL BE LIMITED TO THE DURATION OF THE EXPRESS WARRANTY AND TO THE REPLACEMENT SERVICE AS DETERMINED BY VTECH IN ITS SOLE DISCRETION.

To the extent permitted by law, VTech will not be responsible for direct, special, incidental or consequential damages resulting from any breach of Warranty.

This Warranty is not intended to persons or entities outside the United States of America. Any disputes resulting from this Warranty shall be subject to the final and conclusive determination of VTech .